

**urmet**

|iPer|  
|com|



# IPerCom IP Video door entry system Quick Start Guide

- ① Hardware installation - See the **IPerCom Hardware installation guide**  
(a paper copy is supplied in the folder)

**IMPORTANT** - Peel the MAC address/QR code stickers from the devices as they are being installed, and stick them onto the commissioning forms, not forgetting to fill in the corresponding details on the form.

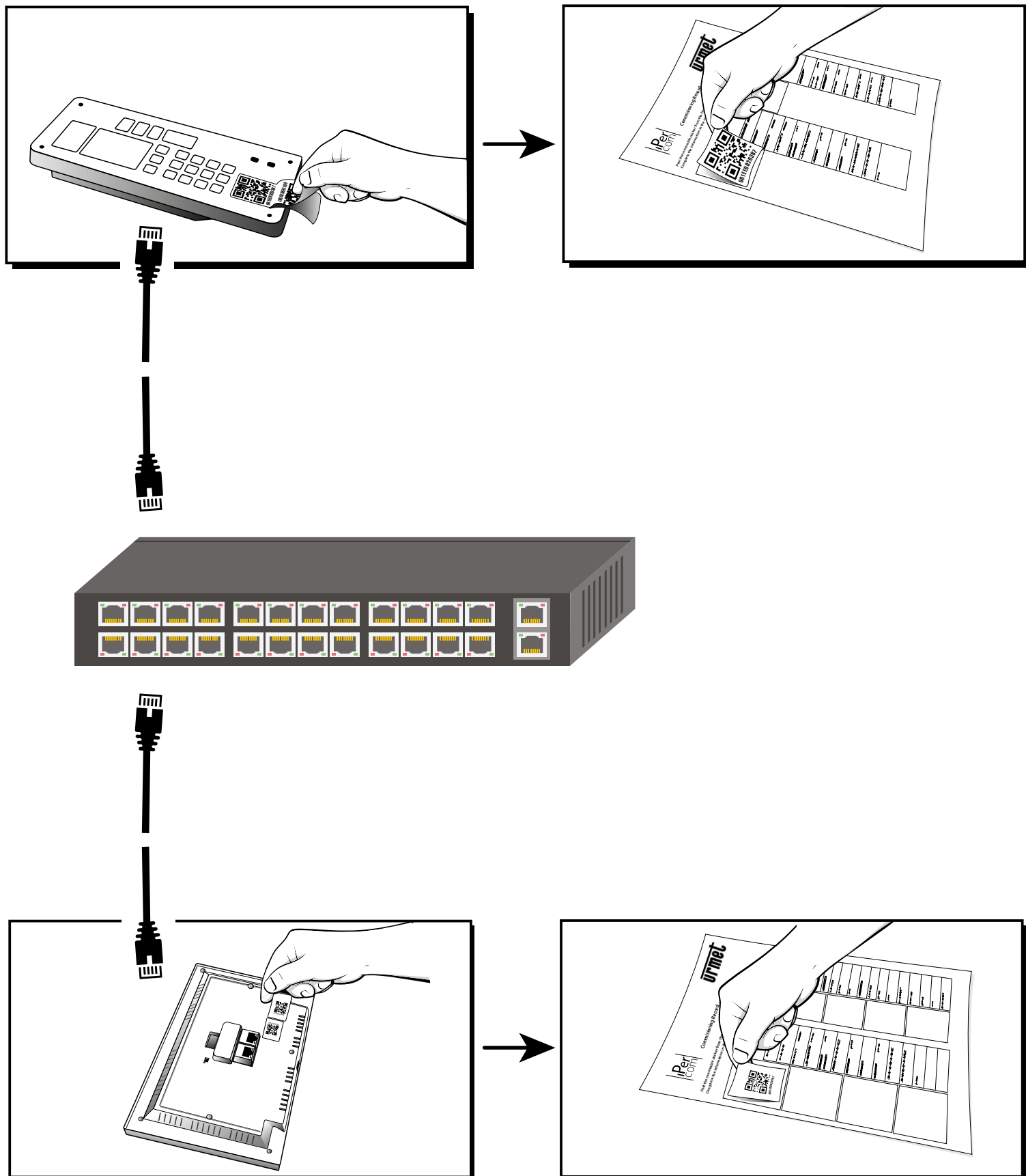

- ② Connect the **Installer** USB flash drive supplied with the **IPerCom Installation Pack** to your PC or laptop.

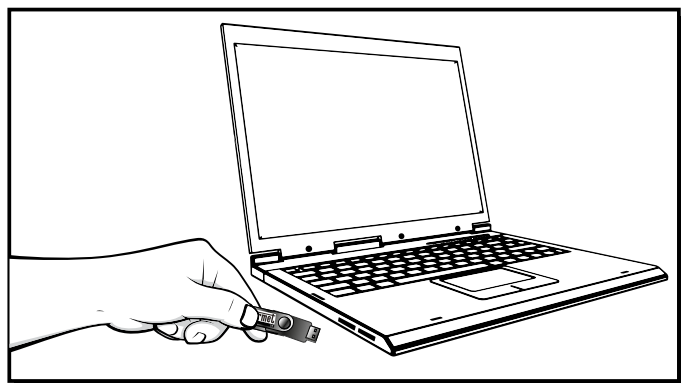

- ③ Browse to the folder named **IPerCom tools**. Open the document titled **IPerUpgrade tool user guide**. Follow this guide to update the system devices to the latest firmware.

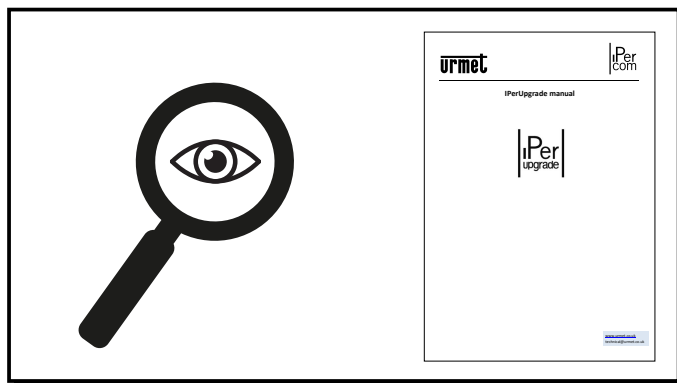

- ④ Browse to the folder named **IPerCom tools**. Open the document titled **IPerCom Installer tool user guide**. Follow this guide to configure the system.

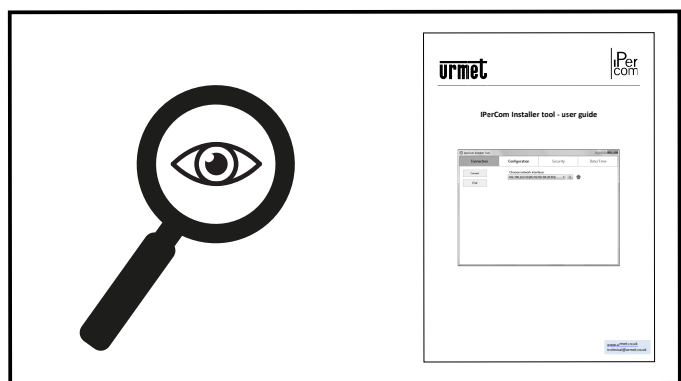

Note - Configuration of the following products and features is covered in the **IPerCom Installer tool - Advanced user guide**;  
**1060/84 Special Decoder**  
**1060/74 Entry Panel**  
**RTSP Camera set up**  
**Proximity Access Control set up**  
**Call Forwarding**  
PC Switchboard setup and lift control are covered in separate guides on the **Installer** USB flash drive.

- ⑥ Pass the **Client** USB flash drive to the customer. It contains all End User information including O & M manuals and user instructions.

- ⑤ Test and commission the system. Commissioning Test Result sheets are provided on the **Installer** USB flash drive.

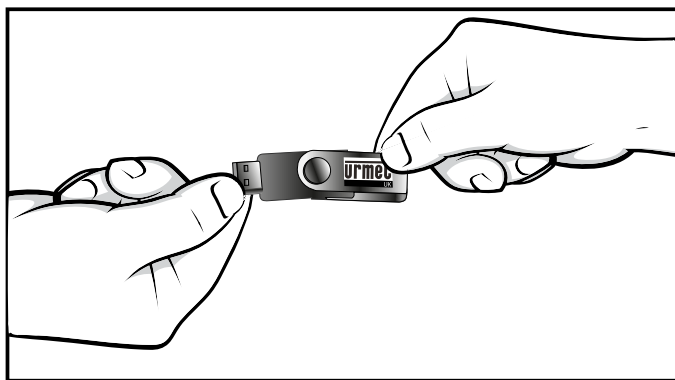
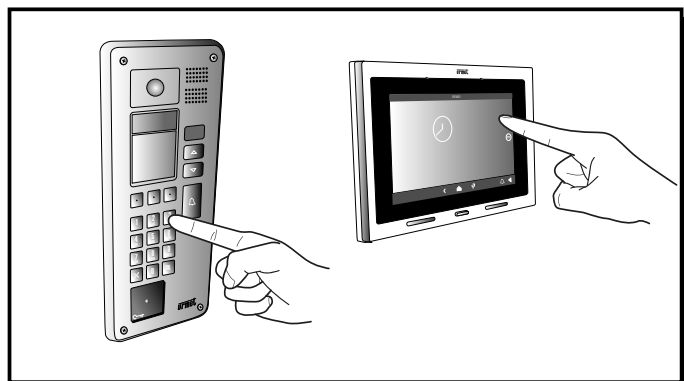



**URMET COMMUNICATION  
AND SECURITY UK LTD**

Urban Hive, Skyline 120,  
Avenue West, Great Notley,  
Essex. CM77 7AA

Tel 01376 556010  
Fax 01376 567874  
[www.urmet.co.uk](http://www.urmet.co.uk)  
[sales@urmet.co.uk](mailto:sales@urmet.co.uk)